

TECHNICAL DATA/

Insulation Material /	PPO
Contact Material /	Copper, Tin plated
Rated Current /	30A
Rated Voltage /	1000V (TUV) 600V (UL)
Test Voltage /	8KV (TUV50HZ,1min)
Contact Resistance /	<0.5mΩ
Degree Of Protection /	IP 67
Ambient Temperature Range /	40℃~ +85℃
Flame Class /	UL 94 V0
Safety Class /	II
Pin Dimensions /	Ø4mm

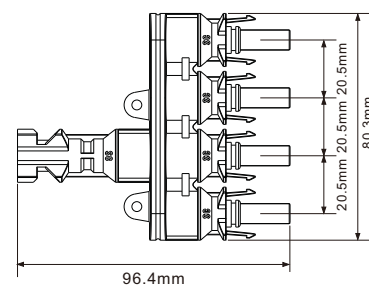
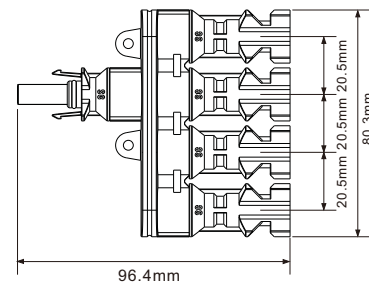

MAIN SPECIALITY

- >> low power loss
- >> With the capacity of anti-aging and resistance to ultraviolet radiation on the outer cover
- >> With convenient installation, strong commonality
- >> To meet the using requirement under bad outdoor condition