

TECHNICAL DATA

| | |
|---------------------------|-----------------------|
| Insulation Material | PPO |
| Contact Material | Copper, Tin plated |
| Suitable Current | 30A |
| Rated Voltage | 1000V (TUV) 600V (UL) |
| Test Voltage | 8KV (TUV50HZ,1min) |
| Contact Resistance | <0.5mΩ |
| Degree Of Protection | IP 67 |
| Ambient Temperature Range | 40℃~ +85℃ |
| Flame Class | UL 94 V0 |
| Safety Class | II |
| Pin Dimensions | Ø4mm |

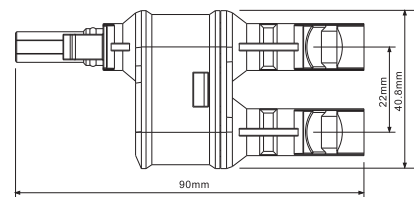
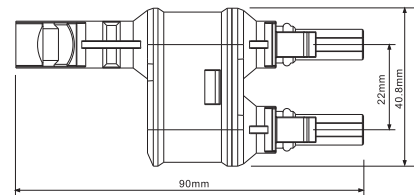

MAIN SPECIALITY

- >> low power loss
- >> With the capacity of anti-aging and resistance to ultraviolet radiation on the outer cover
- >> With convenient installation, strong commonality
- >> To meet the using requirement under bad outdoor condition